



Efficiency lighting combined with heat dissipation design. The solar panel charges at sunny daytime and light at night with the power stored by the battery. The light will dim to set brightness automatically when people leave 8 to 10 meters away and will turn on to full brightness when presence is detected. The design bracket support makes it flexible to install, just insert on the top of a pole. Extreme temperature resistant -10 °C to 45 °C, 3-year warranty, mono-crystalline solar panel, the lithium battery, hybrid function, and an intelligent controller, makes this fixture the best compact solar lighting solution.

## LED Solar Street Light High Output

### Features and benefits

- The lamp adopts integrated structure design, with better heat dissipation design and longer life
- LUXEON 5050 lamp beads, the lighting effect is up to 180lm/W
- The solar panel is made of monocrystalline silicon, with a higher conversion efficiency, up to 18%, and a lifespan of up to 25 years
- MPPT tracking technology, improves system efficiency and reduce costs
- Light sensor and motion-sensing energy-saving mode
- Solar controller built-in lightning protection module
- Using ternary lithium battery technology, the battery capacity is high
- 365 days uninterrupted power

### Applications

- Street lighting, sidewalk, roadway, fence, pathway, campus, park, garden, ramp, boat dock, remote area, farm and ranch lighting.



Intelligent Control System can operate without interruption

1. During the day (charging)
2. Without human body induction at night, 30%
3. With human body induction at night, 100%



ZLPOLE-01-6M

### Distribution curve

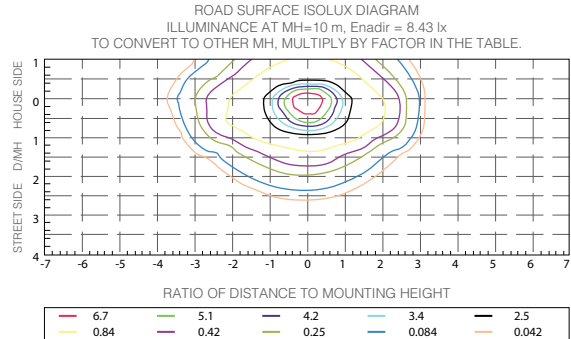
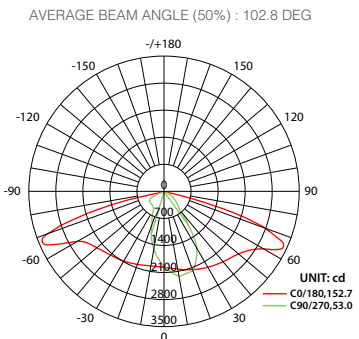

According to LB/T001-2008  
 U = Emin/Eavg = 0.354  
 Eavg = 6.775 lx

HEIGHT	FACTOR
5 m	4.000
6m	2.778
7m	2.041
8m	1.563
9m	1.235
10m	1.000
13m	0.592
11m	0.826
12m	0.694
15m	0.444
16m	0.391



## Technical specifications

Product code	Power	Light output	CCT	Dimensions
ZL100WXXK-SL02-H	100W	18000lm	3000K/4000K/5000K	1556*392*41mm

• **XX** denote the color temperature when is XX=30-40-50, stands for 3000K - 4000K - 5000K  
 3000K/4000K color temperature available under special request.

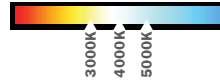

### Optional

ZLPOLE-01-6M	Galvanized steel pole - Black finish	6 meters height
--------------	--------------------------------------	-----------------

<b>Battery</b>	18650 lithium battery 12V 80 Ah
<b>Driver</b>	MeanWell Driver
<b>Input voltage (AC/DC hybrid)</b>	100V-277V
<b>Output voltage (AC/DC hybrid)</b>	48V
<b>Beam angle</b>	150x60°
<b>Pole diameter</b>	60mm
<b>Light output</b>	100W
<b>Luminous flux</b>	18000lm
<b>Color temperature</b>	5000K (4000K / 3000K under special request)
<b>Solar panel</b>	100W/18V monocrystalline silicon (25 years, 80% efficiency)
<b>CRI</b>	>70
<b>Chip brand</b>	Philips Luxeon 5050
<b>LED quantity (PCS)</b>	96
<b>Control mode</b>	Light sensor control + Motion sensor control
<b>Operating time</b>	>12 hours, intelligent mode 3-4 days
<b>Material</b>	Aluminum
<b>Luminous efficiency (lm/W)</b>	>180lm/W
<b>Lifespan</b>	>50,000hrs
<b>IP rating</b>	IP65
<b>Installation height</b>	Suitable for 6-8m height
<b>Size (mm)</b>	L1341.10*W372.99*H174.30
<b>Package quantity (PCS)</b>	1 pcs
<b>Operation ambient temperature</b>	-10° to +45°C, relative humidity 20~90%
<b>Storage ambient temperature</b>	-10° to +35°C, relative humidity 5~95%
<b>Certifications</b>	CE and RoHS

## Dimensions

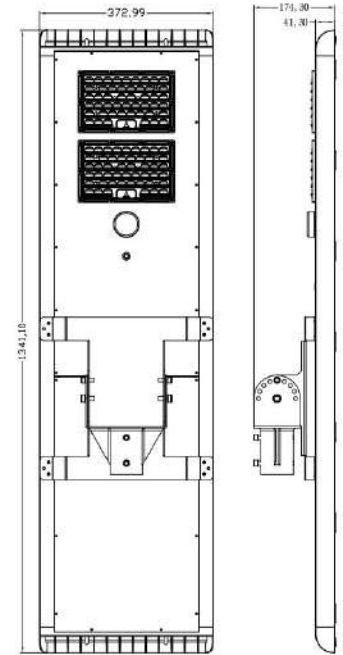

ZL100WXXK-SL02-H

Units: mm

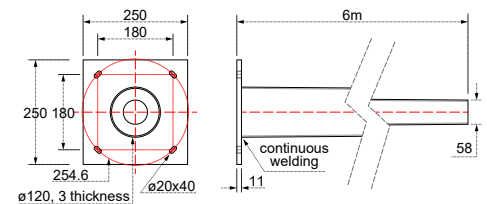

Pole base

Pole side section

Units: mm

## Solar light working mode

### Control model: Light sensor control + Motion sensor control

- **Light sensor control:** In the evening or when the solar panel battery voltage is lower than 3V, the lamp will automatically turn on.
- **Motion sensor control:** A motion-sensing energy-saving mode. When a moving object is sensed, the lamp will have 100% brightness; when no moving object is sensed, the lamp will be in a low-power and energy-saving state, with a brightness of 30%.

\*\* Features a DC detection function. If DC available, the system will automatically switch to lithium battery supply when the battery voltage rise to the DC switching point; the system will automatically switch to DC power supply when the battery voltage falls to the DC switching point; if DC powers off, the system will shut off the output when the battery reaches the over-discharge point after continuous discharging.



**NOTE:** Installation pole NOT included, sold separately. Available upon special request.

### AC/DC Hybrid Function Diagram\*\*

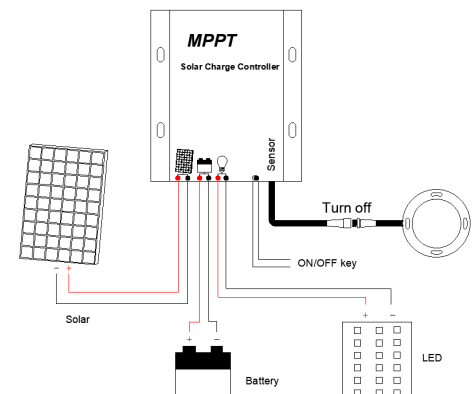

## LED Solar Street Light High Output

Product Code: ZL100W50K-SL02-H

1. When open the package please assure that the light is perfect without any damage.
2. The storage environment temperature of the lamp:  $-10^{\circ}$  to  $+35^{\circ}$ , and the working environment temperature:  $-10^{\circ}$  to  $45^{\circ}$ .
3. The installation location must have sufficient illumination without obstructions; and the normal effective illumination time is 6 to 8 hours.
4. Normal light is sufficient, under normal charge and discharge conditions, the warranty is 3 years.
5. There are pc fittings for the light. It should be handled with care.

### Pole Mounted installation

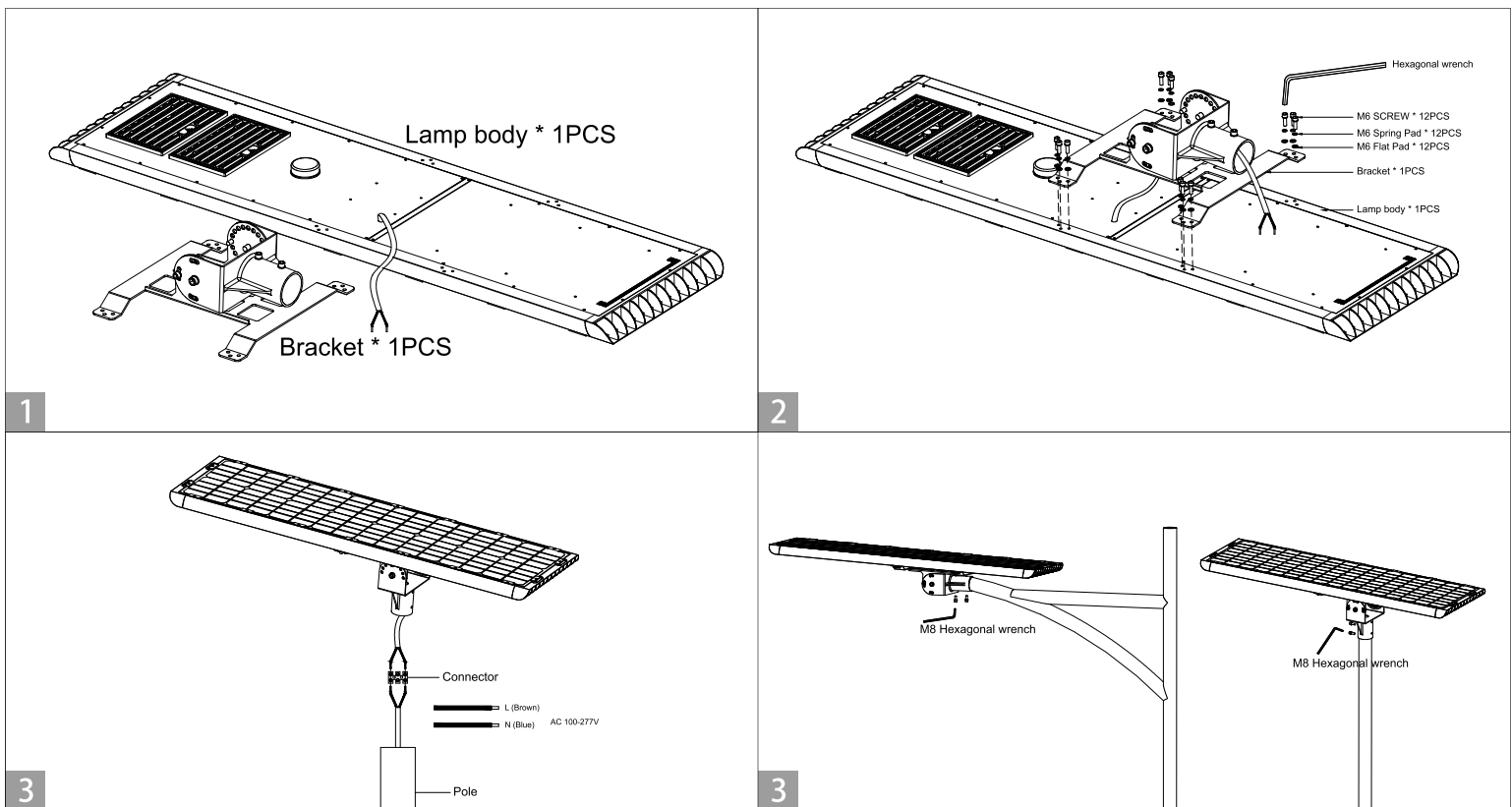

#### Step 1: Check

Unpack and check the surface of the lamp for damage. If any damage is found, do not install.

#### Step 2: Assemble

Use a hexagonal wrench to fix the bracket on the lamp body.

#### Step 3: Wiring

Turn off the utility power. Connect the AC line of the lamp to the mains.

See the indicator light flashes inside the microwave sensor, the lights will turn on at night. The installation is done.

#### Step 4: Fix lamp

Install the lamp on 6 to 8 meters high poles (not included). Fasten the light to the pole and then screw them with wrench until tightened.

• **NOTE:** Installation pole NOT included.